

# Tapintósúcsok

## Gömbtapintó



120059

### Metrikus

A: M2,5 x 0,45

No.	Anyag	SR mm [mm]	L coll [mm]	D Ø [mm]
111460	Acél	5	3	5,5
125258	Acél	5	5	7,9
101119	Acél	7	5	10
120058	Keményfém	5	5	5,5
120059	Keményfém	7	10	7,5
120060	Keményfém	10	10	10,5

## Tárca tapintó - Acél



131365

### Metrikus

A: M2,5 x 0,45

No.	Síklapúság $\mu\text{m}$	Anyag	L coll [mm]	D Ø [mm]
131365	3	Steel	8	5
21AAA340	3	Steel	10	5
101117	5	Steel	10	10
21AAA341	5	Steel	10	15
21AAA342	5	Steel	10	20
21AAA343	5	Steel	10	25
21AAA344	5	Steel	10	30

## Társcsapintó - Keményfém



120056

### Metrikus

A: M2,5 x 0,45

No.	Síklapúság $\mu\text{m}$	Anyag	L coll [mm]	D Ø [mm]	$\phi d$ [mm]
120056	3	Carbide	8	5	2
120041	3	Carbide	5	5,2	4,3
120042	3	Carbide	10	7	6,5
120043	3	Carbide	10	10,5	9,5
21AAA345	5	Carbide	10	17	15
21AAA346	5	Carbide	10	22	20
21AAA347	5	Carbide	10	27	25
21AAA348	5	Carbide	10	32	30
137255		Carbide	10	7	6,4
137399		Carbide	10	9	8

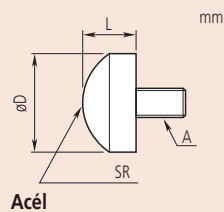

Acél

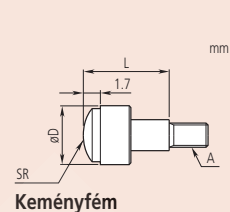

Keményfém

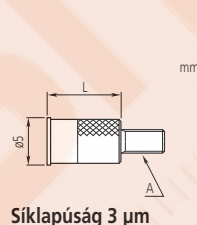

Síklapúság 3  $\mu\text{m}$

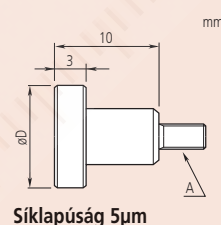

Síklapúság 5  $\mu\text{m}$

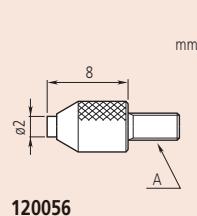

120056

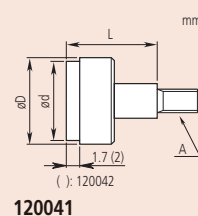

120041

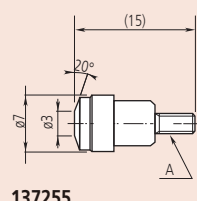

137255

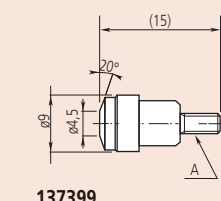

137399

Mindegyik rajzhoz  
A = M2,5x0,45 mm (metrikus)